

CONVENTIONAL SYMBOLS

DESCRIPTION	ABBREVIATION	SYMBOL
BOX CULVERT	BX CULVERT	
BRIDGE	BRIDGE	
BUS STOP	BUS STOP	
CABLE TV PEDESTAL	CABLE TV PED	
CATCH BASIN / INLET	ST DRAIN	
CITY OF DENVER HANDHOLE	COD HH	
CRASH BARRIER	CRASH BARRIER	
CULVERT	CULVERT	
DOWN GUY	DOWN GUY	
EDGE OF PAVEMENT	EOP	
ELECTRICAL MANHOLE	EL MH	
ELECTRIC HANDHOLE	EL HH	
ELECTRIC VAULT	EL VLT	
ELECTRIC WATER PUMP	EL WTR PUMP	
FACE OF CURB	CURB	
FENCE POST	FENCE POST	
FIBER OPTIC CABLE HANDHOLE	FO HH	
FIBER OPTIC CABLE MANHOLE	FO MH	
FIBER OPTIC CABLE PEDESTAL	FO PED	
FIRE HYDRANT	FIRE HYD	
GAS HANDHOLE	GAS HH	
GAS METER	GAS MTR	
GAS VALVE	GAS VLV	
GATE	GATE	
ICG MANHOLE	ICG MH	
INTERMEDIA COMMUNICATIONS MANHOLE	INTERMEDIA MH	
PAYPHONE	PAY PHONE	
PILLAR	PILLAR	
POWER PEDESTAL	PWR PED	
PULLBOX	P EX	
OVER HEAD STRUCTURE	O/H	
ROAD SIGN	SIGN	
SANITARY SEWER MANHOLE	SS MH	
SPLICE	SPLICE	
SPLICE BOX	SPLICE BOX	
SPRINKLER CONTROL BOX	SPRINKLER CONT EX	

SYMBOL KEY

CONVENTIONAL SYMBOLS CONT.

DESCRIPTION	ABBREVIATION	SYMBOL
SPRINKLER HEAD	SPRINKLER	
STEAM MANHOLE	STEAM MH	
STORM SEWER MANHOLE	ST SWR MH	
STREET LIGHT	ST LGT	
SURVEY MARKER	SURVEY MKR	
SWING OR DRAW BRIDGE	SW BRIDGE	
RAILROAD SWITCH BOX	RR SWITCH BX	
TELEPHONE MANHOLE	TEL MH	
TELEPHONE PEDESTAL	TEL PED	
TRAFFIC CONTROL BOX	TFC CTL BX	
TRAFFIC CONTROL HANDHOLE	TFC HH	
TRAFFIC LIGHT	TFC LGT	
TRANSFORMER	TRANSFORMER	
TREE	TREE	
UNIDENTIFIED MANHOLE	UNIDENT MH	
UNIDENTIFIED PEDESTAL	UNIDENT PED	
UTILITY BOX	UTILITY BX	
VENT	VENT	
WATER MANHOLE	WTR MH	
WATER METER	WTR MTR	
WATER VALVE	WTR VLV	
WEATHER TOWER	WEATHER TWR	
WIND DEFLECTOR	WIND DEFLECTOR	

POLE HARDWARE

DESCRIPTION	ABBREVIATION	SYMBOL
EXISTING POWER ANCHOR	EXISTING PWR ANCH	
PROPOSED ANCHOR	PROP ANCH	
EXISTING ANCHOR	TEL ANCH	
SIDEWALK ANCHOR	SIDEWALK ANCH	
BOW TIE	BOW TIE	
EXISTING OVERHEAD GUY	EXISTING OHG	
PROPOSED OVERHEAD GUY	PROP OHG	
EXISTING VERTICAL GROUND	EXISTING VERT GRD	
WIND DEFLECTOR	WIND DEF	

POLE SYMBOLS

DESCRIPTION	ABBREVIATION	SYMBOL
STEEL POLE	STL POLE	
FOREIGN POWER	STEEL FOREIGN PWR	
POWER POLE W/OTHER UTILITIES ATTACHED	PWR POLE	
POWER ONLY	PWR ONLY	
TELEPHONE ONLY	TEL ONLY	

ENGINEERING SYMBOLS

DESCRIPTION	ABBREVIATION	SYMBOL
EXISTING MANHOLE	EX MH	
Adesta PROPOSED MANHOLE	PL MH	
EXISTING HANDHOLE	EX HH	
Adesta PROPOSED HANDHOLE	PL HH	
PERMIT TRACKING FORM IDENTIFIER		
MILE POST MARKER	MP #	
BOND AND GROUND	GRD	

UNDERGROUND UTILITIES

UNKNOWN ELECTRIC	— — P — —
UNKNOWN TV	— — TV — —
UNKNOWN TELEPHONE	— — T — —
UNKNOWN FIBER OPTIC CABLE	— — FO — —
GAS	— — G — —
WATER	— — W — —
STORM SEWER	— — ST — —
SANITARY SEWER	— — SS — —
FOREIGN PIPELINE	— — // — —
OIL LINE	OIL LINE
ABANDONED GAS	— — G — —
ICG	— — ICG — —
LEVEL 3	— — L3 — —
MCI	— — MCI — —
MCLEOD	— — MCLEOD — —
NEXTEL	— — NXT — —
PUBLIC SERVICE CO	— — PSC — —
QWEST	— — QWEST — —
SPRINT	— — SPRINT — —
STEAM	— — SPRINT — —
TCI	— — TCI — —
USW	— — JSW — —

OVERHEAD UTILITIES

ELECTRIC/POWER	— — OHP — —
TV	— — TV — —
TELEPHONE	— — T — —

MISC. SYMBOL

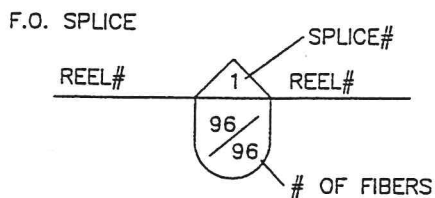

MARKER LEGEND

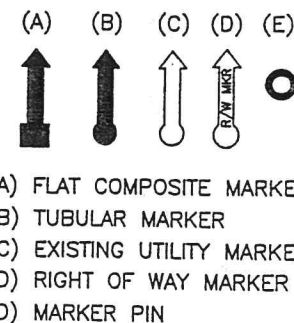

LINE DESCRIPTION LINE TYPE

EXISTING CONDUIT W/ INNERDUCTS	
PROPOSED CONDUIT W/ INNERDUCTS	
PROPOSED STEEL PIPE	
BEGIN/END OF BORE	
DIRECTIONAL BORE	
PROPOSED AERIAL CABLE	
BARBED WIRE FENCE	
CHAIN-LINKED FENCE	
RAILROAD	
CENTERLINE	
PROPERTY LINE	
RIGHT-OF-WAY	
DITCH	
HIGH BANK	
SECTION LINE	
CURB FACE	
BACK OF CURB	
SILT FENCE	
EDGE OF PAVEMENT	
GUARD RAIL	
TREE LINE	
WATER	
CONCRETE WALL OR SOUND BARRIER	

AS-BUILT

STATION NUMBERS (STA) IS A UNIT OF MEASUREMENT CALCULATED IN LINEAR FEET



1200 Landmark Center,
Suite 1300
Omaha, Nebraska 68102

Project Office:
6275 Joyce Drive
Golden, Colorado 80403-7541

PROJECT NO.:
901013

COLORADO DEPARTMENT
OF TRANSPORTATION
SYMBOLS SHEET

REVISION STATUS

DATE	BY	DESCRIPTION

ORIGIN BY:	SDV
DATE OF ORIGIN:	12/07/01
DRAWN BY:	
DATE DRAWN:	
APPVD BY:	RTD
DATE APPVD:	3/8/02
FINAL APPROVAL:	

**** NOTICE ****
INFORMATION ON THIS DOCUMENT IS PROPRIETARY AND SHALL NOT BE USED, COPIED, REPRODUCED OR DISCLOSED IN WHOLE OR IN PART WITHOUT WRITTEN CONSENT OF ADESTA

CAD FILENAME: SYM12
SHEET: SYM-001
SCALE: NOT TO SCALE

NOTE:
1. O/S ARE TAKEN FROM SOUTH EOP
OF FRONTAGE RD

Stratton
exit 419
#2

KIT CARSON COUNTY



1200 Landmark Center,
Suite 1300
Omaha, Nebraska 68102

Project Office:
6275 Joyce Drive
Golden, Colorado 80403-7541

PROJECT NO.:
902060

COLORADO DEPARTMENT
OF TRANSPORTATION
INTERSTATE 70 EAST
LINK 3B

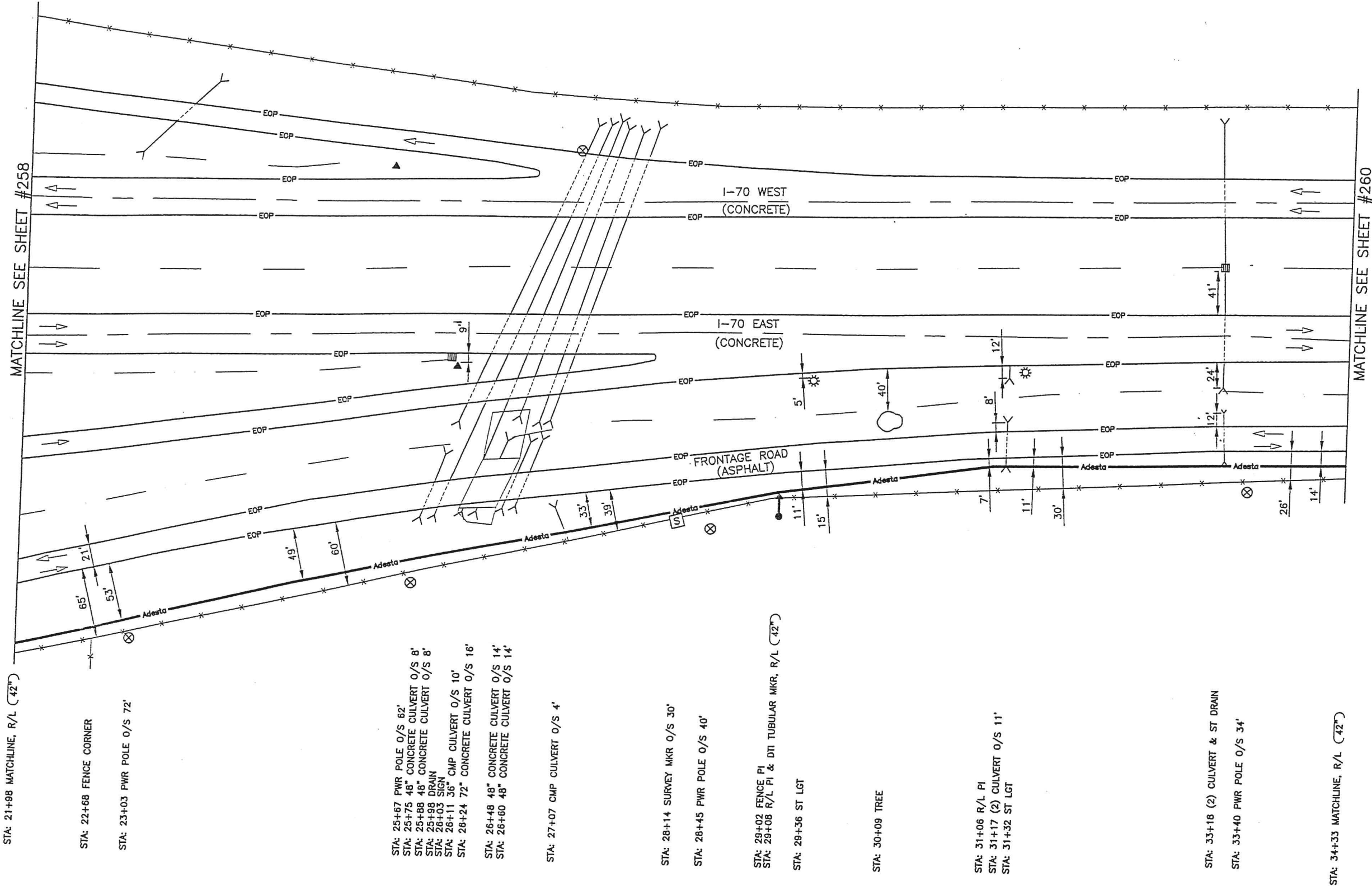

CLARIFICATION NO. QUANTITY

CLARIFICATION NO.	QUANTITY

REVISION STATUS

DATE	BY	DESCRIPTION
9/01	JLS	STATIONING

ORIGIN. BY:
DATE OF ORIGIN:
DRAWN BY: KBH
DATE DRAWN: 05/02/01
APPVD BY: RSO
DATE APPVD: 3/16/02
FINAL APPROVAL: RSO

**** NOTICE ****
INFORMATION ON THIS DOCUMENT IS PROPRIETARY AND SHALL NOT BE USED, COPIED, REPRODUCED OR DISCLOSED IN WHOLE OR IN PART WITHOUT WRITTEN CONSENT OF ADESTA

AG-BUILD

- NOTE:
- 0/S ARE TAKEN FROM SOUTH EOP OF I-70 EAST EXIT #419 & SOUTH EOP FRONTAGE RD
 - FROM STA: 16+59 TO 17+29 R/L IS 68 FEET

Stratton
exit 419
#1



KIT CARSON COUNTY

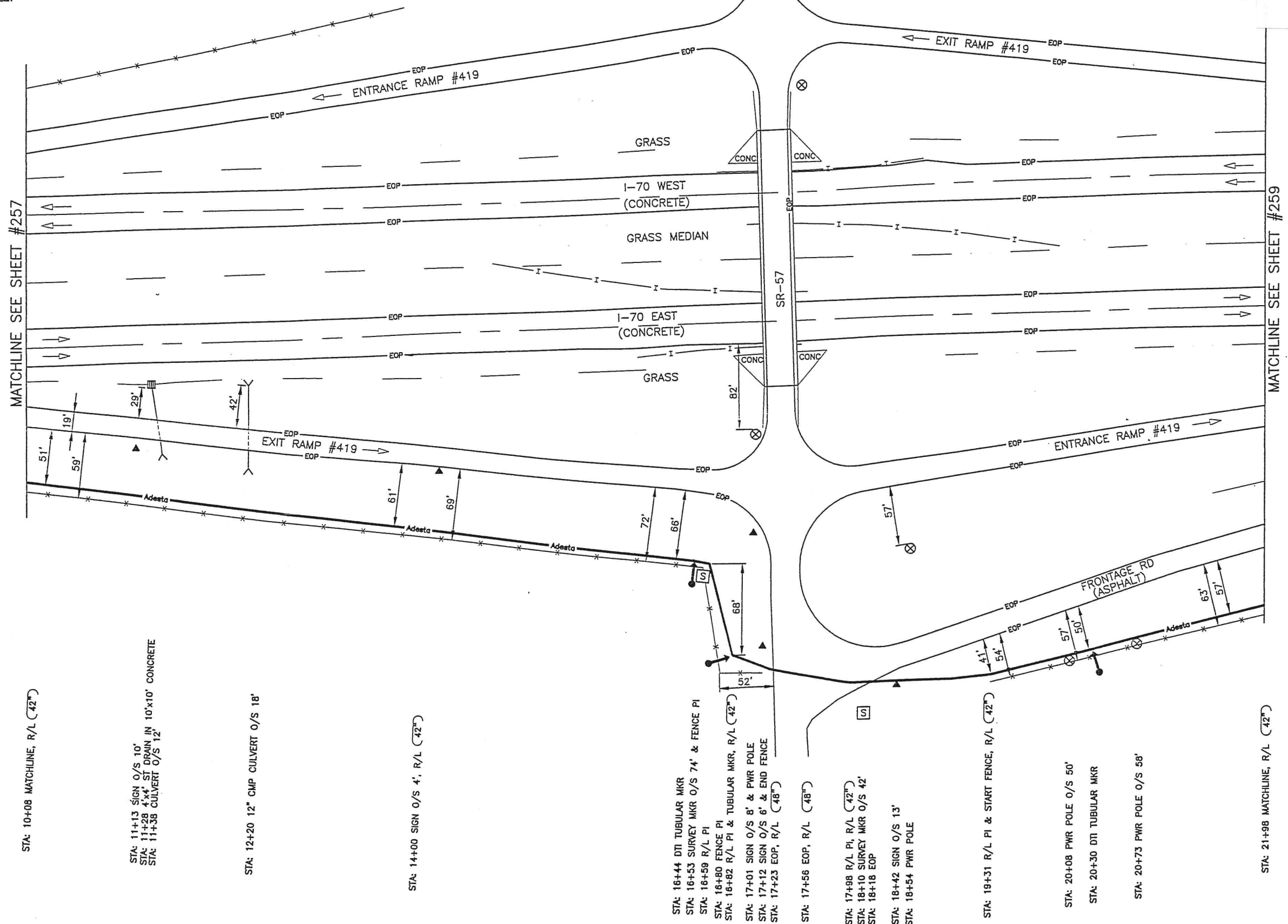

MATCHLINE SEE SHEET #257

MATCHLINE SEE SHEET #259

STA: 10+08 MATCHLINE, R/L (42')

STA: 11+13 SIGN O/S 10'
STA: 11+28 4"x4" ST DRAIN IN 10"x10" CONCRETE
STA: 11+38 CULVERT O/S 12'

STA: 12+20 12" CMP CULVERT O/S 18'

STA: 14+00 SIGN O/S 4', R/L (42')

STA: 16+44 DTI TUBULAR MKR
STA: 16+53 SURVEY MKR O/S 74' & FENCE PI
STA: 16+59 R/L PI
STA: 16+80 FENCE PI
STA: 16+82 R/L PI & TUBULAR MKR, R/L (42')
STA: 17+01 SIGN O/S 8' & PWR POLE
STA: 17+12 SIGN O/S 6' & END FENCE
STA: 17+23 EOP, R/L (48')

STA: 17+56 EOP, R/L (48')

STA: 17+98 R/L PI, R/L (42')
STA: 18+10 SURVEY MKR O/S 42'
STA: 18+18 EOP

STA: 18+42 SIGN O/S 13'
STA: 18+54 PWR POLE

STA: 19+31 R/L PI & START FENCE, R/L (42')

STA: 20+08 PWR POLE O/S 50'
STA: 20+30 DTI TUBULAR MKR

STA: 20+73 PWR POLE O/S 59'

STA: 21+98 MATCHLINE, R/L (42')

6275 Joyce Drive Golden, Colorado 80403-7541		
PROJECT NO.: 902060		
COLORADO DEPARTMENT OF TRANSPORTATION INTERSTATE 70 EAST LINK 3B		
CLARIFICATION NO.	QUANTITY	
REVISION STATUS		
DATE	BY	DESCRIPTION
9/01	JLS	STATIONING
ORIGIN. BY:		
DATE OF ORIGIN:		
DRAWN BY: KBH		
DATE DRAWN: 05/02/01		
APPVD BY: [Signature]		
DATE APPVD: 3/8/02		
FINAL APPROVAL: [Signature]		
**** NOTICE **** INFORMATION ON THIS DOCUMENT IS PROPRIETARY AND SHALL NOT BE USED, COPIED, REPRODUCED OR DISCLOSED IN WHOLE OR IN PART WITHOUT WRITTEN CONSENT OF ADESTA		
CAD FILENAME: JB-258		
SHEET: 258 OF: 399		
SCALE: NOT TO SCALE		

AS-BUILT

Hi-Plains
(Seibert)
exit 405 #2

Seibert 13

NOTE:
1. O/S ARE TAKEN FROM SOUTH EOP
OF EXIT RAMP & ENTRANCE RAMP

KIT CARSON COUNTY



1200 Landmark Center,
Suite 1300
Omaha, Nebraska 68102

Project Office:
6275 Joyce Drive
Golden, Colorado 80403-7541

PROJECT NO.:
902060

COLORADO DEPARTMENT
OF TRANSPORTATION
INTERSTATE 70 EAST
LINK 3B

CLARIFICATION NO. QUANTITY

REVISION STATUS

DATE	BY	DESCRIPTION
8/01	PL	STATIONING

ORIGIN. BY:

DATE OF ORIGIN:

DRAWN BY: JLS

DATE DRAWN: 6/15/01

APPVD BY: *RTO*

DATE APPVD: 3/6/02

FINAL APPROVAL: *TJL*

2/9/02

**** NOTICE ****
INFORMATION ON THIS
DOCUMENT IS PROPRIETARY
AND SHALL NOT BE USED,
COPIED, REPRODUCED OR
DISCLOSED IN WHOLE OR
IN PART WITHOUT WRITTEN
CONSENT OF ADESTA

CAD FILENAME: 3B-195

SHEET: 195 OF: 399

SCALE: NOT TO SCALE

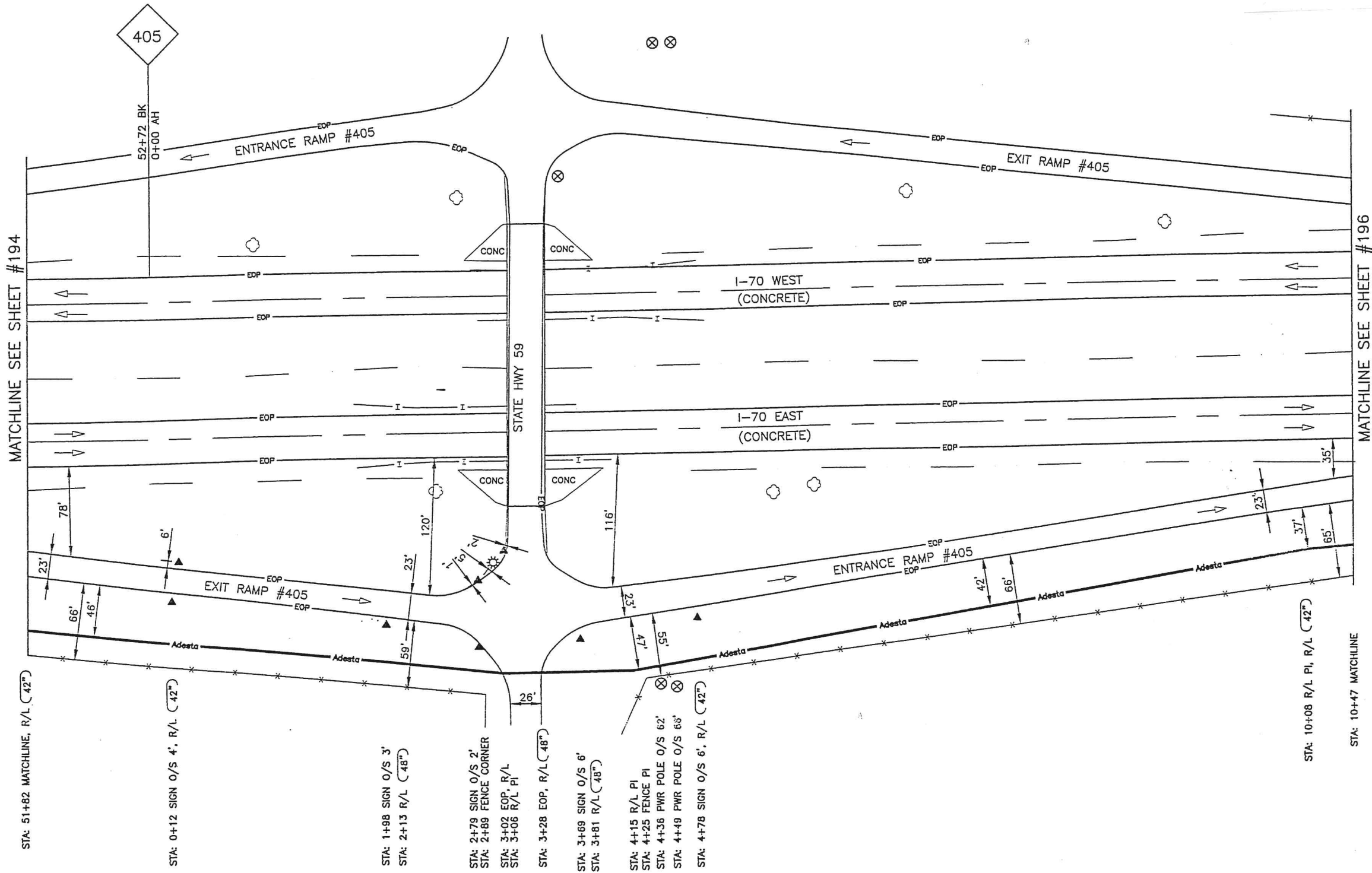

MATCHLINE SEE SHEET #194

MATCHLINE SEE SHEET #196

STA: 51+82 MATCHLINE, R/L (42°)

STA: 0+12 SIGN O/S 4', R/L (42°)

STA: 1+98 SIGN O/S 3'
STA: 2+13 R/L (48°)

STA: 2+79 SIGN O/S 2'
STA: 2+89 FENCE CORNER
STA: 3+02 EOP, R/L
STA: 3+06 R/L PI

STA: 3+28 EOP, R/L (48°)

STA: 3+89 SIGN O/S 6'
STA: 3+81 R/L (48°)

STA: 4+15 R/L PI
STA: 4+25 FENCE PI
STA: 4+36 PWR POLE O/S 62'
STA: 4+49 PWR POLE O/S 68'
STA: 4+78 SIGN O/S 6', R/L (42°)

STA: 10+08 R/L PI, R/L (42°)

STA: 10+47 MATCHLINE

AS-BUILT

OUTH EOP
RAMP

KIT CARSON COUNTY

Hi-Plains
(Seibert)
exit 405
#1

Seibert A



1200 Landmark Center,
Suite 1300
Omaha, Nebraska 68102

Project Office:
6275 Joyce Drive
Golden, Colorado 80403-7541

PROJECT NO.:
902060

COLORADO DEPARTMENT
OF TRANSPORTATION
INTERSTATE 70 EAST
LINK 3B

CLARIFICATION NO. QUANTITY

REVISION STATUS

DATE BY DESCRIPTION
2/01 PL STATIONING

ORIGIN BY:

DATE OF ORIGIN:

DRAWN BY: JLS

DATE DRAWN: 6/15/01

APPVD BY: [Signature]

DATE APPVD: 3/8/02

FINAL APPROVAL: [Signature]

3/8/02

**** NOTICE ****
INFORMATION ON THIS
DOCUMENT IS PROPRIETARY
AND SHALL NOT BE USED,
COPIED, REPRODUCED OR
DISCLOSED IN WHOLE OR
IN PART WITHOUT WRITTEN
CONSENT OF ADESTA

CAD FILENAME: 3B-194

SHEET: 194 OF: 399

SCALE: NOT TO SCALE

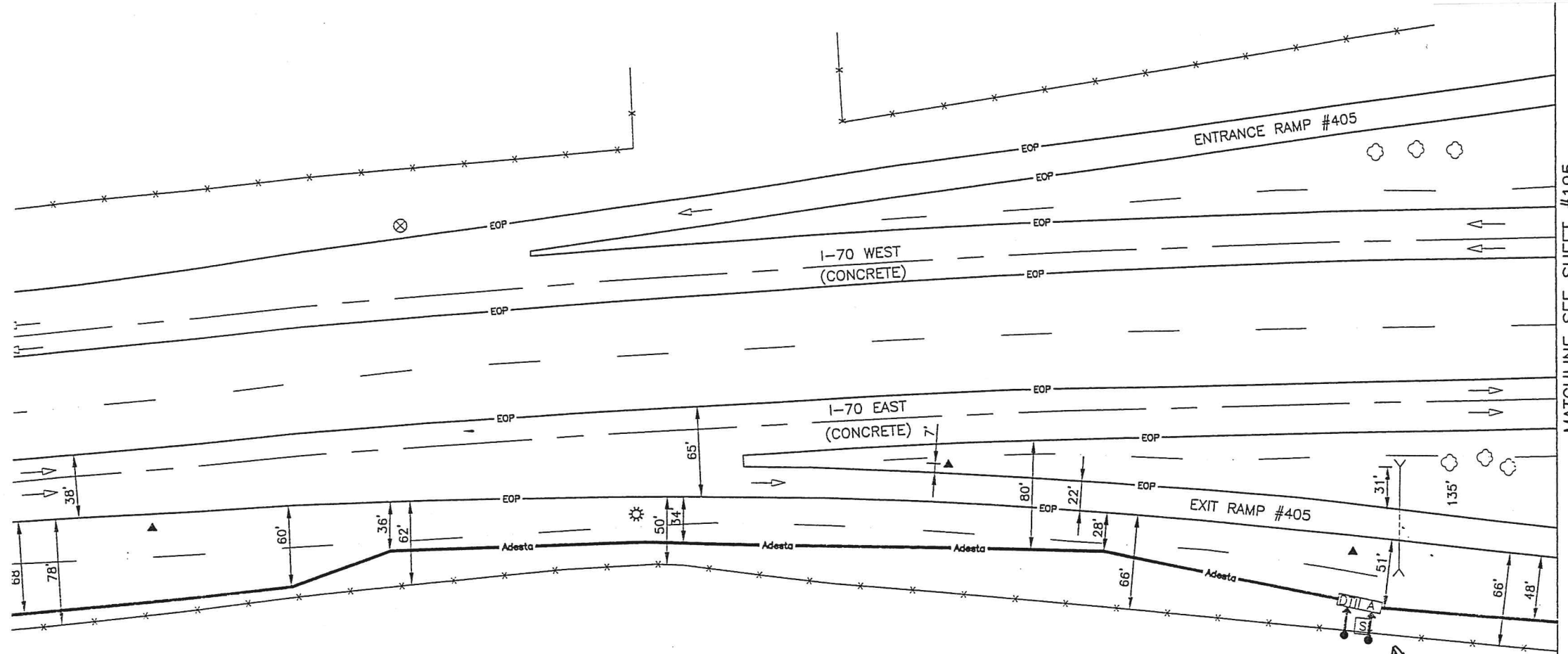

MATCHLINE SEE SHEET #195

- STA: 40+37 MATCHLINE, R/L (42°)
- STA: 41+48 SIGN O/S 6', R/L (42°)
- STA: 42+44 R/L PI, R/L (42°)
- STA: 43+20 R/L PI, R/L (42°)
- STA: 45+00 ST LGT O/S 10'
- STA: 45+22 FENCE PI, R/L (42°)
- STA: 48+43 R/L PI, R/L (42°)
- STA: 50+29 DTI HH #404.50 & TUBULAR MKR
- STA: 50+33 SIGN O/S 84'
- STA: 50+41 SURVEY MKR O/S 136'
- STA: 50+47 ADESTA HH #404.50, TUBULAR MKR & R/L PI
- STA: 50+66 CULVERT O/S 101'
- STA: 51+82 R/L (42°)
- STA: 51+82 MATCHLINE

AS-BUILT

O/S ARE TAKEN FROM SOUTH EOP OF I-70 EAST

Limon
 Hwy. 71
 Overpass #1

Limon d.r. (40252910414/15)

LINCOLN COUNTY



1200 Landmark Center,
 Suite 1300
 Omaha, Nebraska 68102

Project Office:
 6275 Joyce Drive
 Golden, Colorado 80403-7541

PROJECT NO.:
 902060

COLORADO DEPARTMENT
 OF TRANSPORTATION
 INTERSTATE 70 EAST
 LINK 3A

CLARIFICATION NO.	QUANTITY

REVISION STATUS		
DATE	BY	DESCRIPTION
9/01	PL	STATIONING

ORIGIN. BY:
 DATE OF ORIGIN:
 DRAWN BY: JLS
 DATE DRAWN: 4/30/01
 APPVD BY: *[Signature]*
 DATE APPVD: 3/8/02
 FINAL APPROVAL: *[Signature]*
 2/9/12

**** NOTICE ****
 INFORMATION ON THIS DOCUMENT IS PROPRIETARY AND SHALL NOT BE USED, COPIED, REPRODUCED OR DISCLOSED IN WHOLE OR IN PART WITHOUT WRITTEN CONSENT OF ADESTA

CAD FILENAME: 3A-392
 SHEET: 392 OF: 402
 SCALE: NOT TO SCALE

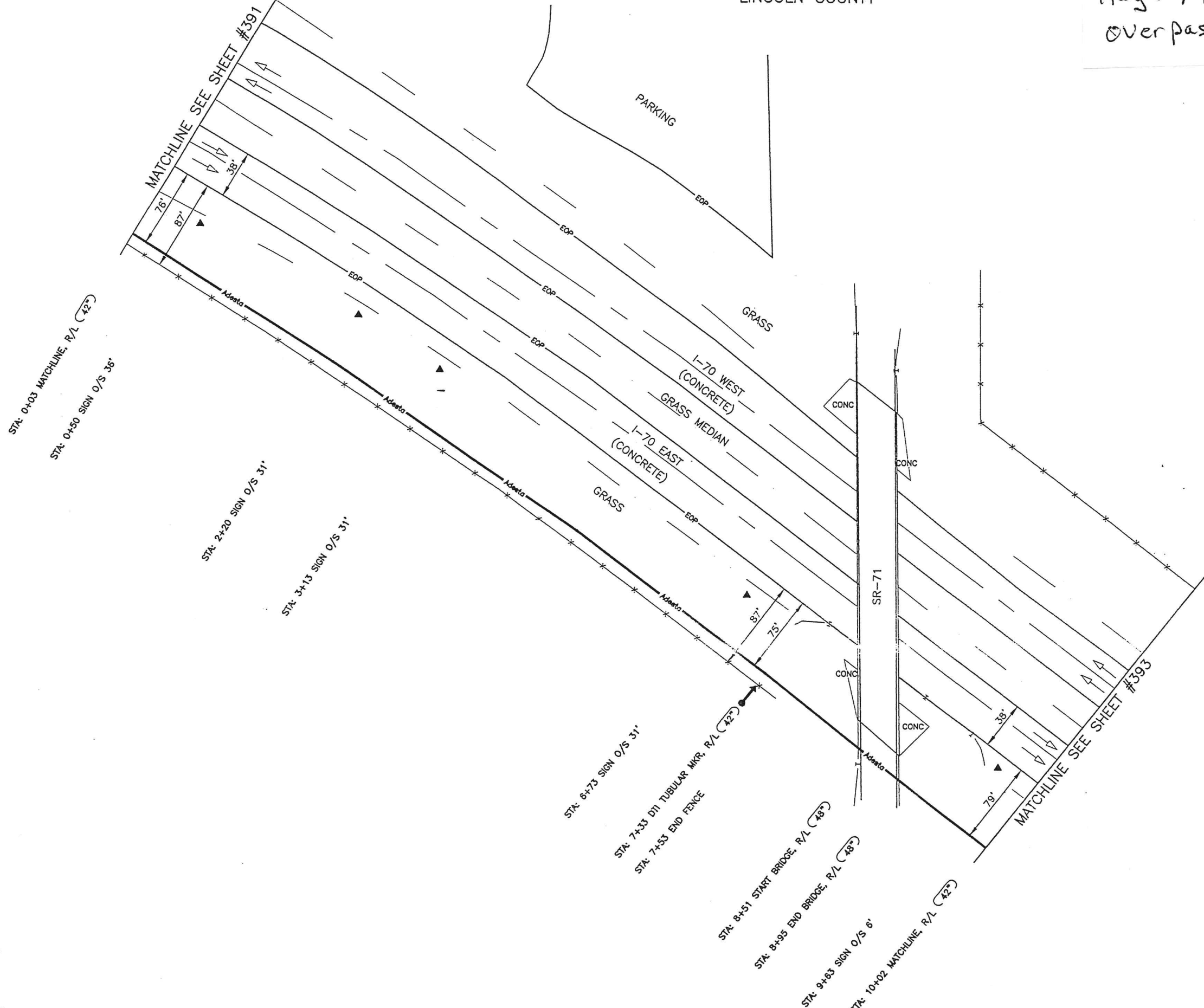

AS-BUILT

O/S ARE TAKEN FROM SOUTH EOP OF I-70 EAST & EXIT RAMP

LINCOLN COUNTY

Limon exit 359



Project Office:
6275 Joyce Drive
Golden, Colorado 80403-7541

PROJECT NO.:
902060

COLORADO DEPARTMENT
OF TRANSPORTATION
INTERSTATE 70 EAST
LINK 3A

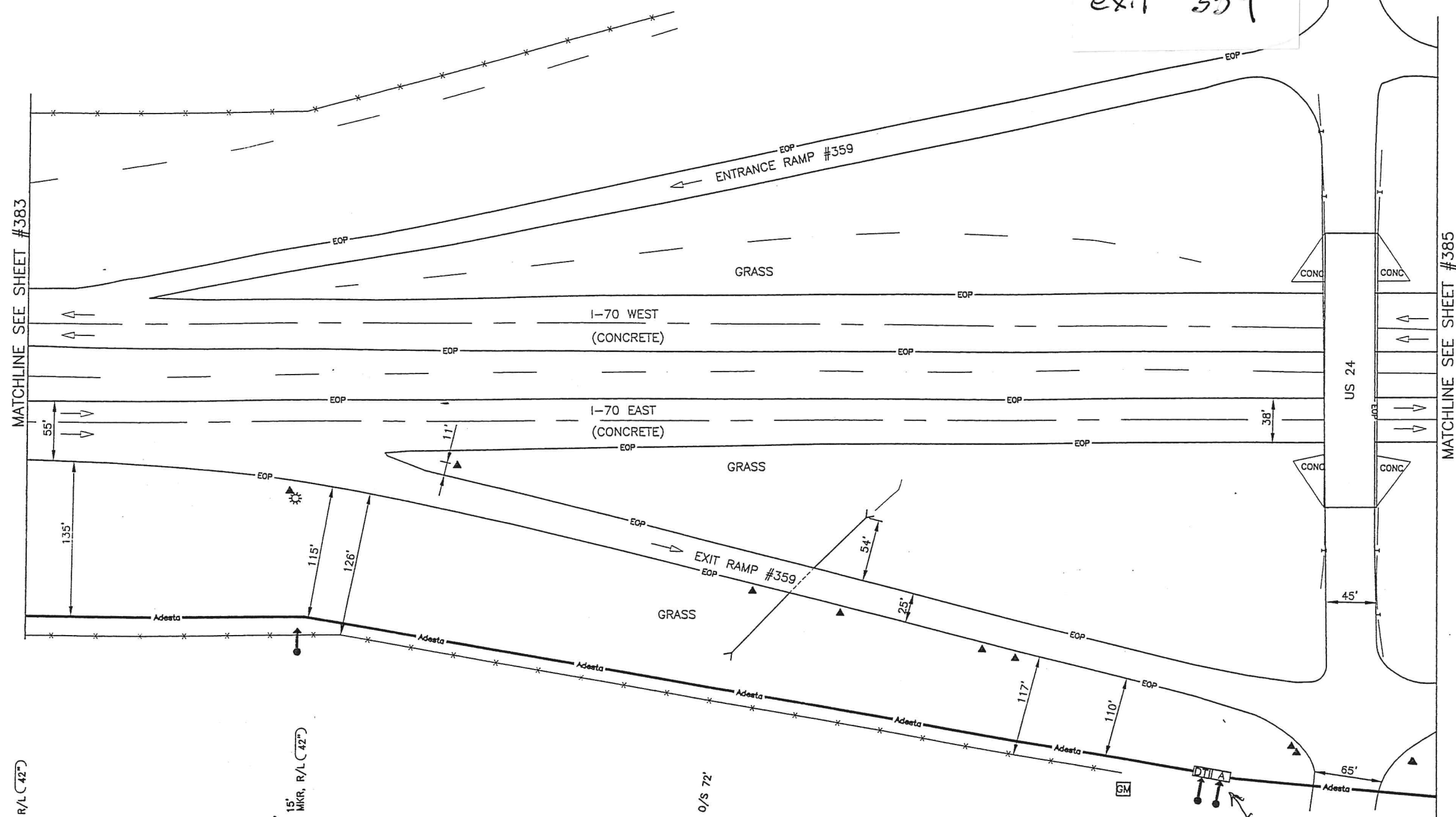

STA: 15+00 MATCHLINE, R/L (42°)

STA: 17+24 SIGN O/S 6'
STA: 17+29 ST LGT O/S 15'
STA: 17+33 DTI TUBULAR MKR, R/L (42°)
STA: 17+38 R/L PI

STA: 18+44 SIGN

STA: 21+06 48" CONCRETE CULVERT O/S 72'
STA: 21+14 SIGN O/S 6'

STA: 21+88 SIGN O/S 6'

STA: 23+14 SIGN O/S 6'

STA: 23+44 SIGN O/S 6'

STA: 24+53 END FENCE
STA: 24+56 GAS MTR

STA: 25+22 DTI HH #359+26 & TUBULAR MKR
STA: 25+32 ADESTA HH #359+26 & TUBULAR MKR

STA: 25+84 SIGN O/S 3'
STA: 25+98 SIGN O/S 3'
STA: 26+16 EOP & GUARDRAIL, R/L (180°)

STA: 26+73 GUARDRAIL
STA: 26+75 EOP, R/L (210°)

STA: 27+02 SIGN O/S 12'
STA: 27+25 MATCHLINE, R/L (150°)

AS-BUILT

Table with 2 columns: CLARIFICATION NO., QUANTITY. Multiple empty rows.

Table with 3 columns: DATE, BY, DESCRIPTION. Row 1: 9/01, PL, STATIONING.

Table with 2 columns: ORIGIN, BY; DATE OF ORIGIN; DRAWN BY; DATE DRAWN; APPVD BY; DATE APPVD; FINAL APPROVAL.

**** NOTICE ****
INFORMATION ON THIS DOCUMENT IS PROPRIETARY AND SHALL NOT BE USED, COPIED, REPRODUCED OR DISCLOSED IN WHOLE OR IN PART WITHOUT WRITTEN CONSENT OF ADESTA

CAD FILENAME: 3A-384
SHEET: 384 OF: 402
SCALE: NOT TO SCALE

NOTE: 1. O/S ARE TAKEN FROM SOUTH EOP OF I-70 EAST

ARAPAHOE COUNTY

Deer Trail
exit 328



1200 Landmark Center,
Suite 1300
Omaha, Nebraska 68102
Project Office:
6275 Joyce Drive
Golden, Colorado 80403-7541
PROJECT NO.:
902060

COLORADO DEPARTMENT
OF TRANSPORTATION
INTERSTATE 70 EAST
LINK 3A

STA: 14+46 MATCHLINE, R/L (42')

STA: 15+96 SIGN O/S 76'

STA: 17+33 TREE O/S 48'
STA: 17+38 DTI TUBULAR MKR, R/L (48')
STA: 17+59 START BRIDGE
STA: 17+79 SIGN O/S 72'
STA: 17+90 PWR POLE O/S 62'
STA: 17+97 EOP LGT O/S 68'
STA: 17+99 SY R/L (193')

STA: 18+32 EOP, R/L PI, R/L (72')
STA: 18+59 TREE O/S 52'
STA: 18+67 DTI TUBULAR MKR
STA: 18+50 END BRIDGE
STA: 18+70 PWR POLE O/S 50'

STA: 19+22 TREE O/S 50'

STA: 20+25 PWR POLE O/S 52' GUY WIRE & R/L PI, R/L (48')

STA: 21+84 DTI HH #328.22 & TUBULAR MKR R/L (42')
STA: 21+94 ADESTA HH #328.22 & TUBULAR MKR
STA: 22+23 SIGN O/S 46'
STA: 22+32 MATCHLINE

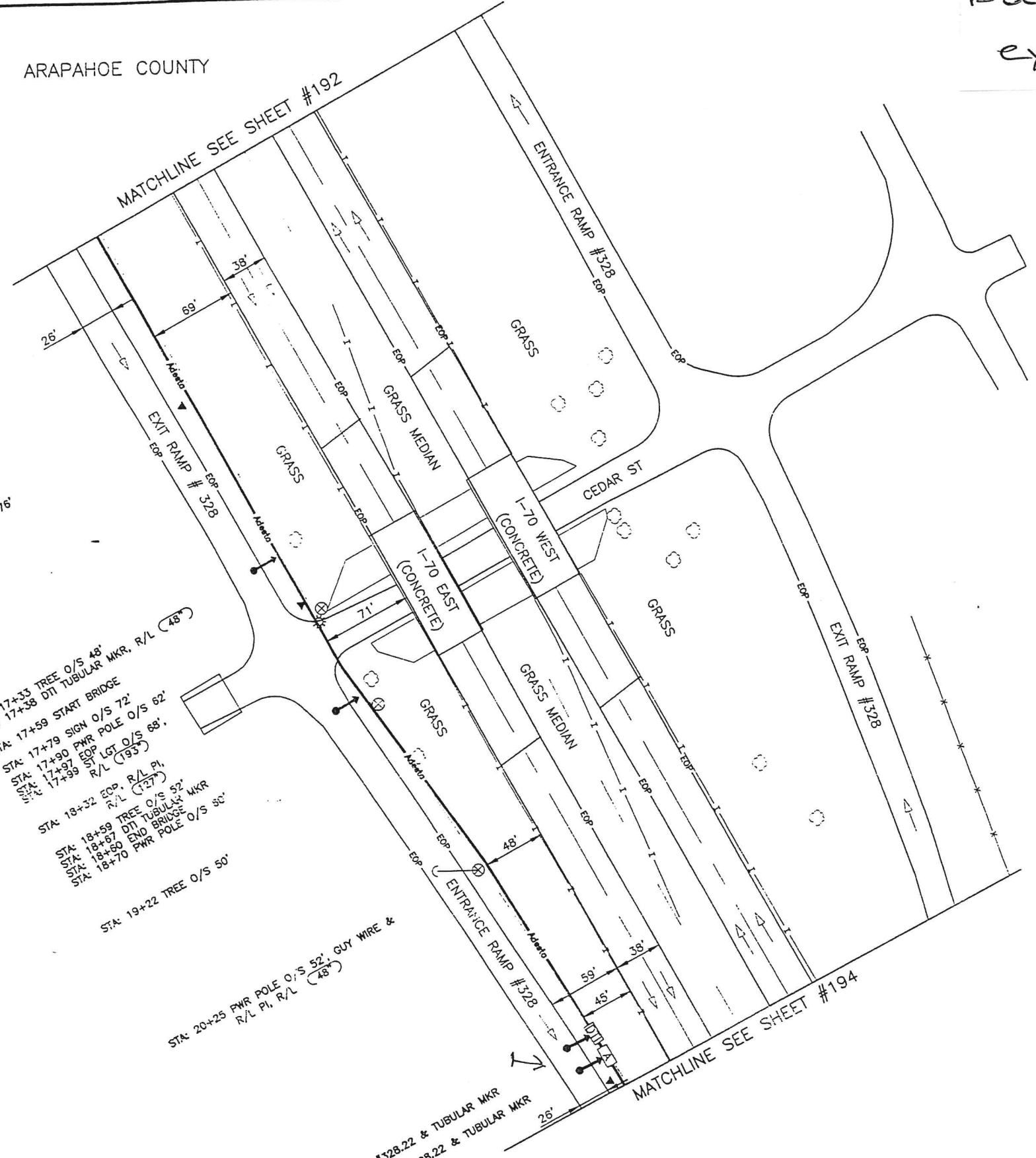

CLARIFICATION NO.	QUANTITY

REVISION STATUS		
DATE	BY	DESCRIPTION
9/01	PL	STATIONING
10/8	BAJ	DEPTH

ORIGIN BY:
DATE OF ORIGIN:
DRAWN BY: PL
DATE DRAWN: 4/25/01
APPROV BY: *[Signature]*
DATE APPROV: *[Signature]*
FINAL APPROVAL: *[Signature]*
[Signature]

**** NOTICE ****
INFORMATION ON THIS DOCUMENT IS PROPRIETARY AND SHALL NOT BE USED, COPIED, REPRODUCED OR DISCLOSED IN WHOLE OR IN PART WITHOUT WRITTEN CONSENT OF ADESTA
CAD FILENAME: 3A-193
SHEET: 193 OF: 402
SCALE: NOT TO SCALE

1/AS-211

Byers
exit 316



1200 Landmark Center,
Suite 1300
Omaha, Nebraska 68102
Project Office:
6275 Joyce Drive
Golden, Colorado 80403-7541
PROJECT NO.:
902060

COLORADO DEPARTMENT
OF TRANSPORTATION
INTERSTATE 70 EAST
LINK 3A

CLARIFICATION NO.	QUANTITY

REVISION STATUS		
DATE	BY	DESCRIPTION
9/01	JLS	STATIONING

ORIGIN. BY:
DATE OF ORIGIN:
DRAWN BY: KBH
DATE DRAWN: 04/21/01
APPVD BY: [Signature]
DATE APPVD: 05/02
FINAL APPROVAL: [Signature]
07/19/02

**** NOTICE ****
INFORMATION ON THIS DOCUMENT IS PROPRIETARY AND SHALL NOT BE USED, COPIED, REPRODUCED OR DISCLOSED IN WHOLE OR IN PART WITHOUT WRITTEN CONSENT OF ADESTA

CAD FILENAME: 3A-129
SHEET: 129 OF: 402
SCALE: NOT TO SCALE

SOUTH EOP
STAGE RD

ARAPAHOE COUNTY

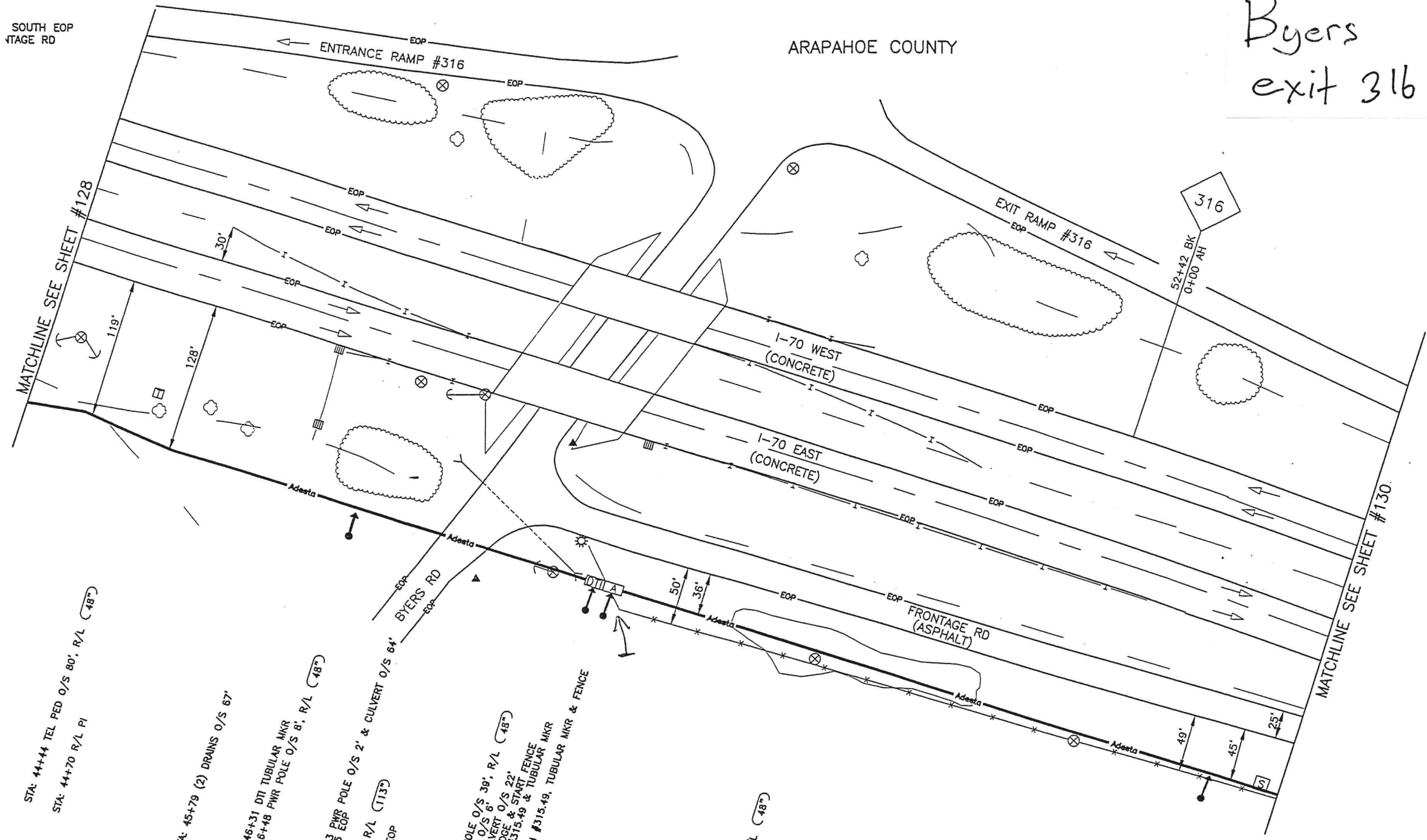

STA: 44+44 TEL PED O/S 80', R/L (48°)
STA: 44+70 R/L PI

STA: 45+79 (2) DRAINS O/S 67'

STA: 46+31 DTI TUBULAR MKR
STA: 46+48 PWR POLE O/S 8', R/L (48°)
STA: 47+03 PWR POLE O/S 2' & CULVERT O/S 64'
STA: 47+05 EOP
STA: 47+27 R/L (113°)
STA: 47+47 EOP

STA: 48+07 PWR POLE O/S 39', R/L (48°)
STA: 48+22 ST LGT O/S 6'
STA: 48+25 28" CULVERT O/S 22'
STA: 48+29 END BRIDGE & START FENCE
STA: 48+44 DTI BRIDGE
STA: 48+49 DTI DRAIN #315.49 & TUBULAR MKR
STA: 48+59 ADESTA FH #315.49, TUBULAR MKR & FENCE
STA: 48+69 FENCE PI

STA: 49+62 START TREES

STA: 50+39 PWR POLE O/S 49', R/L (48°)

STA: 51+80 END TREES

STA: 0+32 PWR POLE O/S 45', R/L (48°)

STA: 1+50 DTI TUBULAR MKR

STA: 1+95 SURVEY MKR O/S 35', R/L (48°)
STA: 2+10 MATCHLINE

AS-BUILT

Bennett TT 304

Bennett
exit 304

NOTES:
1. O/S ARE TAKEN FROM SOUTH EOP
OF EXIT RAMP & ENTRANCE RAMP

ADAMS COUNTY

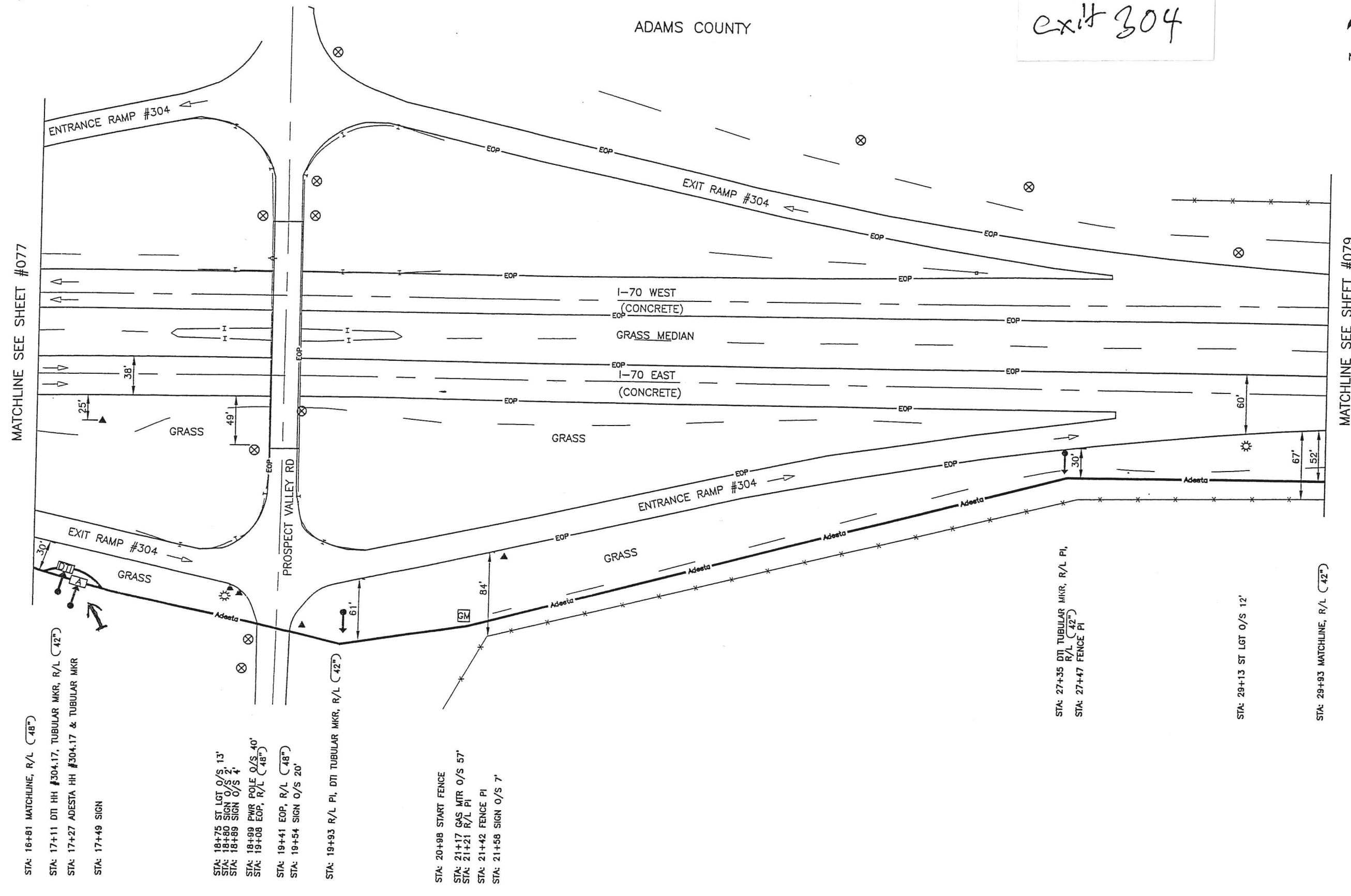

MATCHLINE SEE SHEET #077

MATCHLINE SEE SHEET #079

STA: 16+81 MATCHLINE, R/L (48")

STA: 17+11 DTI HH #304.17, TUBULAR MKR, R/L (42")

STA: 17+27 ADESTA HH #304.17 & TUBULAR MKR

STA: 17+49 SIGN

STA: 18+75 ST LOT O/S 13'
STA: 18+80 SIGN O/S 2'
STA: 18+89 SIGN O/S 4'

STA: 18+99 PWR POLE O/S 40'
STA: 19+08 EOP, R/L (48")

STA: 19+41 EOP, R/L (48")
STA: 19+54 SIGN O/S 20'

STA: 19+93 R/L PI, DTI TUBULAR MKR, R/L (42")

STA: 20+98 START FENCE

STA: 21+17 GAS MTR O/S 57'

STA: 21+21 R/L PI

STA: 21+42 FENCE PI

STA: 21+58 SIGN O/S 7'

STA: 27+35 DTI TUBULAR MKR, R/L PI,
R/L (42")
STA: 27+47 FENCE PI

STA: 29+13 ST LGT O/S 12'

STA: 29+93 MATCHLINE, R/L (42")

ARAPAHOE COUNTY

AS-BUILT

OR
DAI
DR
DAI
APP
DAT
FIN
**:
II
DOC
AM
CO
DS
IN
CAD
SHE

